

# Liberty Grandview

## PORTABLE Series

Projection Screen

### U-Work Series

The perfect solution for table-top projector display

As the portable LED projector and mobile phones with projection capabilities are gaining popularity, the U-Work screen offers an excellent viewing experience compared to the traditional laptop and brings customers a better viewing experience for portable business. The latest design of the U-Work screen with the self-stand base foot allows the screen to be stopped at any desired position.

- Extreme portability - the 40"U-Work screen only weighs 1.3KG.
- One button locking mechanism allows the screen to be unlocked automatically when turning out the base foot.
- Using the self-standing arm, the screen can be stopped at any desired position.



U-work A 40"~60"	U-work B 25"~40"
---------------------	---------------------

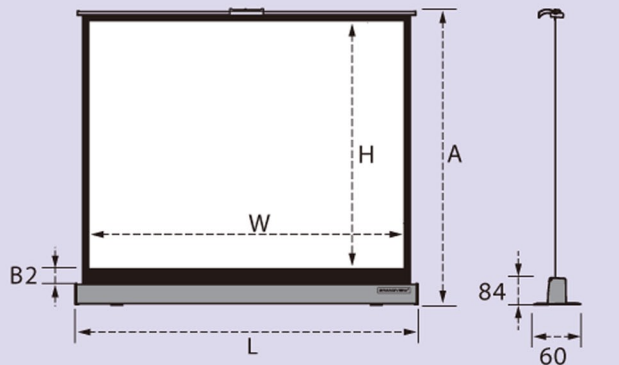
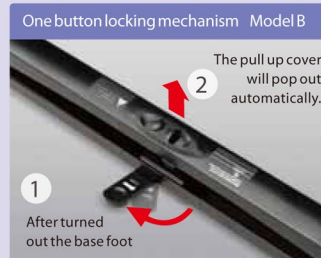

Front View(Model A)

Side View

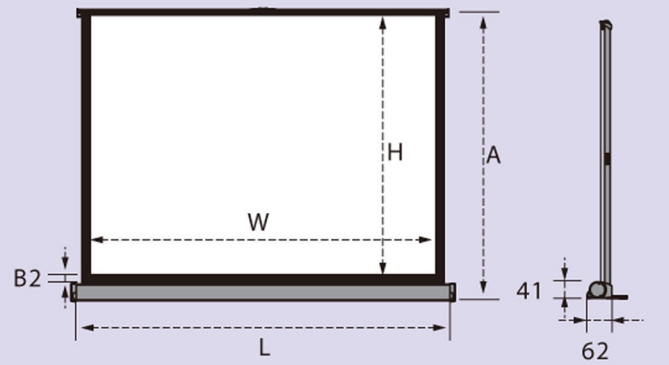

Front View(Model B)

Side View

### U-Work Series (PT-Uxxx)

Ratio	Diagonal	Viewing Area	End Cap	L	Down Black Border B2	Retraction Height A	N. Weight
	(Inch)	(W×H)					(kg)
4:3	25	508 x 381	B	626	20	414	0.85
	32	650 x 488	B	742	20	566	1.08
	40	813 x 610	B	905	20	688	1.30
	50	1016x 762	A	1124	200	900	2.80
	60	1219x 914	A	1327	200	1080	3.20



AV-VISION EQUIPMENTS (INDIA) PVT. LTD.  
 Mktg. Off: 1-20-248, 2nd Floor, Rasoolpura, ('SNOWCEM' Lane)  
 SECUNDERABAD- 500 003, Telangana, INDIA.  
 Tele : +91-(0)40-6722 2555, 6722 2549, TOLL FREE (BSNL): 1800-425-2936  
 E-mail: sales@av-visionindia.co.in  
 www.av-visionindia.co.in

SCAN QR CODE

